

BACKYARD ...STAGE... AT THE ST AUGUSTINE AMPHITHEATRE

1340C A1A SOUTH, ST. AUGUSTINE, FLORIDA 32080



Located at the St. Augustine Amphitheatre, the **BACKYARD STAGE** offers a unique setting, production and amenities for artists looking to play venues with a flexible 200-1,200 capacity crowd.

The stage is located in between the backstage area of the Amphitheatre and the State Park Arboretum. There is ample room to fit local food trucks, beer tents, merch areas and a sizeable crowd. The intimate vibe created is ideally that of a smaller venue appealing to the punk, indie, alt-country and hip-hop shows that are looking to play the NE Florida area. There is a large, growing audience of music lovers in the area and such a space will be greatly welcomed!

Being located onsite of the Amphitheatre means that artists will have full use of facilities and amenities offered at the Amphitheatre (dressing rooms, showers, laundry, Wi-Fi, shore-power for buses, etc.). Not only that, but the Amphitheatre staff will work above and beyond to make your artists feel comfortable, welcome and excited about the experience. Past and upcoming shows include: Clutch, Son Volt, THEE OH SEES, The Black Angels, NRBQ, Lera Lynn, The Oh Hellos, the Baseball Project, Protomartyr, Israel Nash and more.

PRODUCTION INFORMATION

Backyard Stage Address: 1320 A1A South, St. Augustine, FL 32080

Capacity:

- 1,000

Stage Specification:

- Stage Dimensions: 30' W x 25' D x 3' H
- Metal Roof: 17' at peak / 14' at sides
 - *Roof is not rated for hanging points*
 - *All systems must be ground supported*

Stage Power:

- 50A – RV Style Plug
 - In-House Power Distro:
 - 6 – 20A Edison Outlets
 - 3 – 30A L14-30 Outlets
- 50A - RV Style Plug
 - In-House Power Distro:
 - 4 - 20A Edison Outlets
 - 8 - 20A Edison Outlets (Breakout Boxes)
 - 1 - 30A L14-30 Outlet
- 30A – L14-30 Plug
- 30A – L14-30 Plug
- 20A – Edison Outlets – Separate Circuits
 - Stage Right – 1 Quad Box
 - Stage Left – 2 Quad Boxes
 - Stage Left - 1 Duplex Box

Curfew:

- 10:00 PM on Sunday through Thursday
- 10:30 PM on Friday and Saturday

Sound Limit:

- Sound levels must not exceed 95 dB SPL A-weighted as measured from the FOH Mix Position.

Facilities & Amenities:

- Dressing Rooms
- Showers
- Laundry
- Wi-Fi
- Shore Power

TECHNICAL INFORMATION

Type	Qty.	Description
Audio	8	EAW KF730 LINE ARRAY
	2	EAW KF 730 Fly Bar
	4	EAW SB850 Subwoofer
	1	POWERSOFT X8 RACK
	1	EAW RL18 -- DRUM SUB
	2	QSC K8 -- FRONT FILL
	1	Ramtech Split 3
	1	Mic Box 3 BLUE
	1	Mic Stand Package 3
	1	Crown iTech 6000 4 Mix
	6	EAW SM500
	1	AVID SC48 DIGITAL MIXING CONSOLE - DIGI SNAKE
	1	SC48 Ethernet Stage Rack
	1	SC48 ETHER SNAKE
	1	AVID SC48 Digital Mixing Console -Analog I/O

Lighting		
Rental	4	Martin MAC 101 LED Wash
Rental	24	Color Kinetics ColorBlast 12 TR
Rental	1	Avolite Quartz Lighting Console

Audio Labor	1	FOH Technician
Audio Labor	1	Monitor Technician
Lighting Labor	1	Lighting Technician

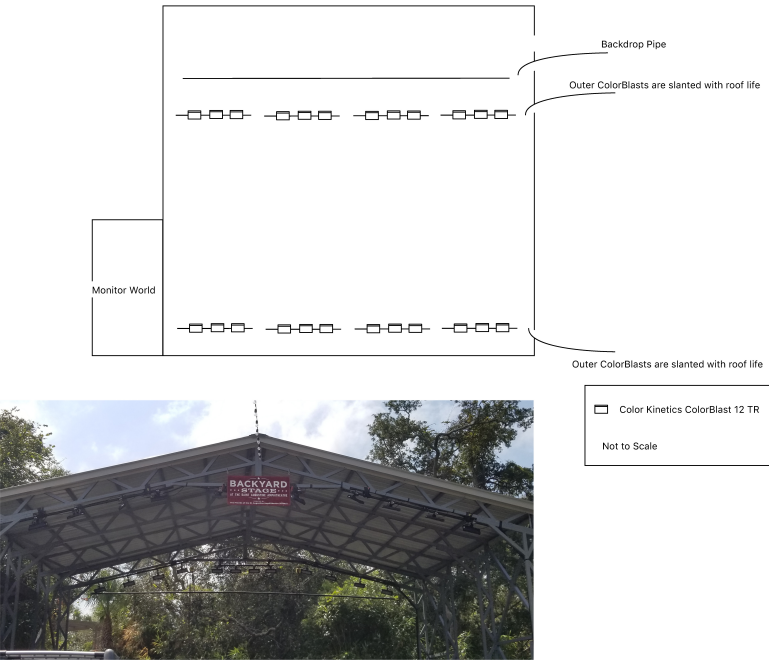

Backstage Access & Loading

1320 A1A South, St. Augustine, FL 32080

The service road leading to backstage is located approximately 500' north of the main entrance on state road A1A.

Bus Parking & Shore Power

Two (2) buses (or additional trucks) can park in the alley immediately behind the main stage building. Shore power is available.

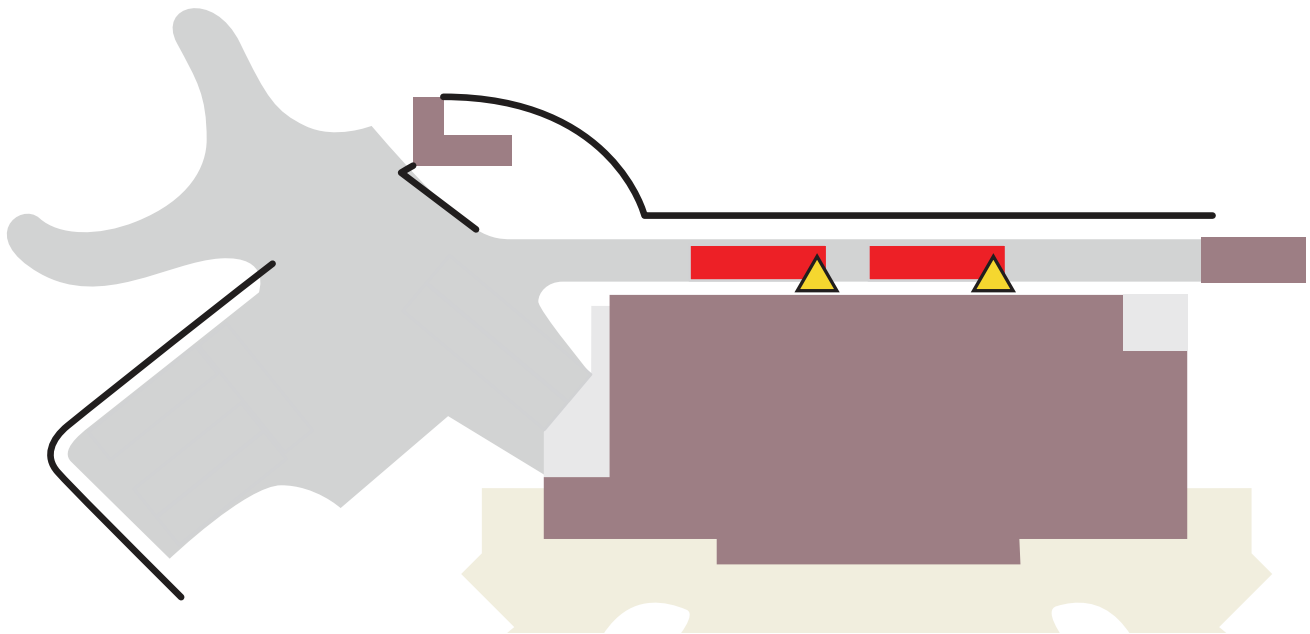

The **RED** rectangles indicate a parking spot typically used for a bus.
Every **YELLOW** triangle represents an outlet for shore power.

Navigating Backstage

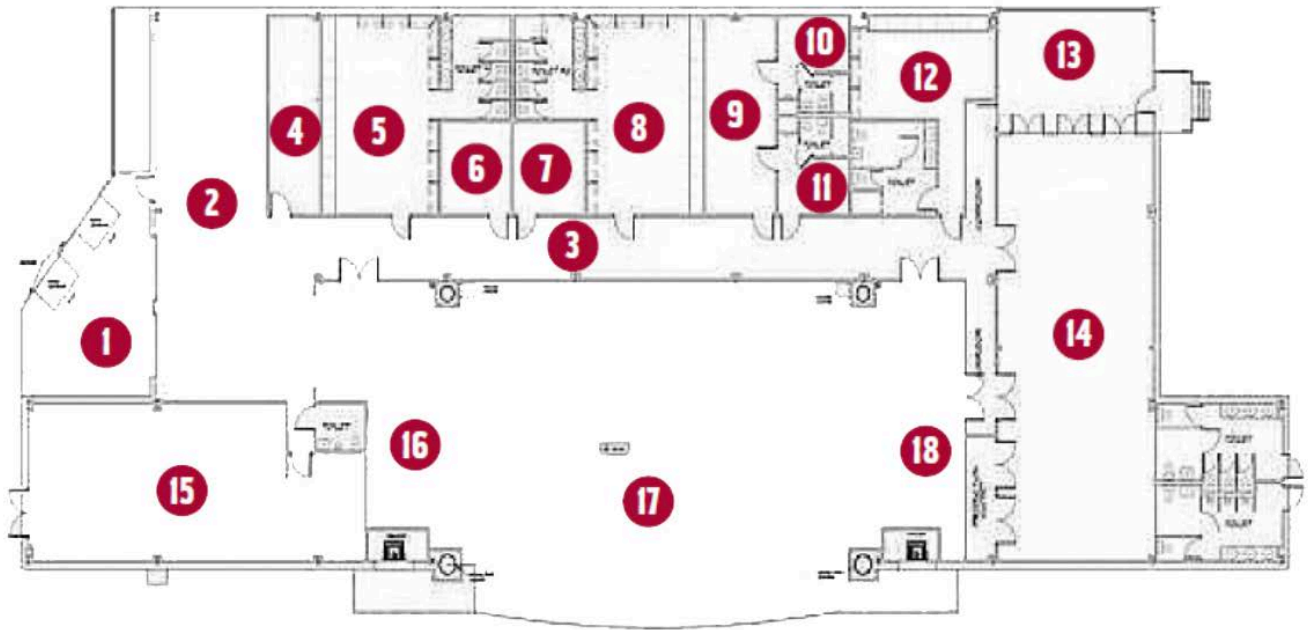

- | | | |
|---------------------|------------------------|-------------------|
| 1. Loading Dock | 7. Operations/Promoter | 13. Covered Porch |
| 2. Storage Area | 8. Dressing Room 1 | 14. Catering |
| 3. Backstage Hall | 9. Dressing Room 2 | 15. Kitchen |
| 4. Electrical Room | 10. Dressing Room 2B | 16. Stage Right |
| 5. Tour Production | 11. Dressing Room 3 | 17. Stage |
| 6. House Production | 12. Dressing Room 4 | 18. Stage Left |

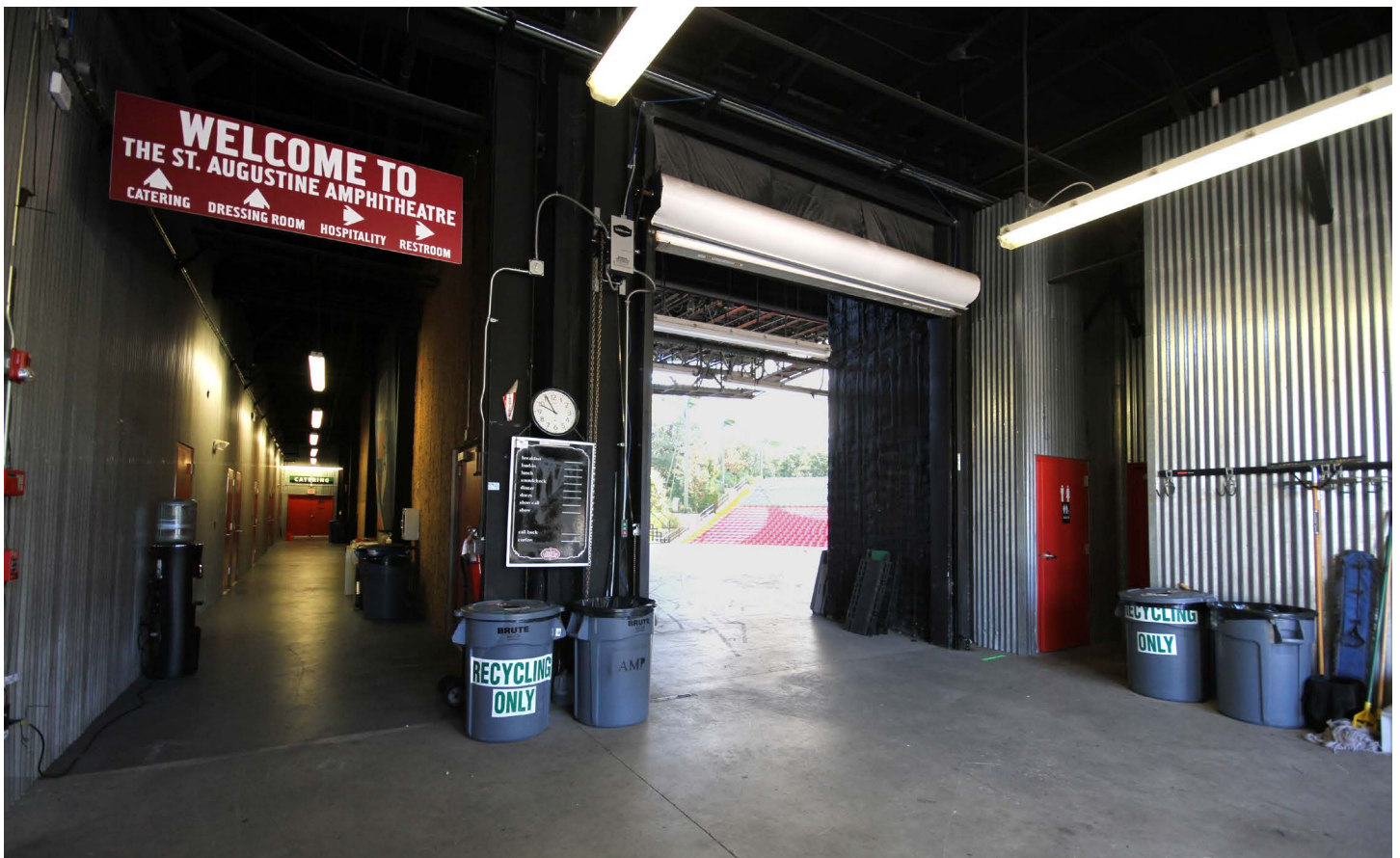

Directions

The St. Augustine Amphitheatre is located on Anastasia Island in St. Augustine, Florida. The main entrance and box office are located at 1340C A1A South, St. Augustine, FL, 32080. For Semi's and Buses, use the service road at 1320 A1A South, St. Augustine, FL, 32080 (500' north of the marquee/main entrance on A1A).

Traveling North:

Take I-95 North to Exit 311 SR 207 North towards St. Augustine.
Make a right onto SR 207 North and continue for 3.7 miles.
Make a right onto SR 312 East towards St. Augustine Beach and continue for 3.6 miles.
Make a left onto A1A North and continue for 1.1 miles.
The St. Augustine Amphitheatre will be on your right.

Traveling South:

Take I-95 South to Exit 311 SR 207 North towards St. Augustine.
Make a left onto SR 207 North and continue for 3.7 miles.
Make a right onto SR 312 East towards St. Augustine Beach and continue for 3.6 miles.
Make a left onto A1A North and continue for 1.1 miles.
The St. Augustine Amphitheatre will be on your right.

***Please Note: This is the easiest path for semi's/buses. Other GPS routes will take you through downtown, a draw bridge, much smaller streets, and traffic.**

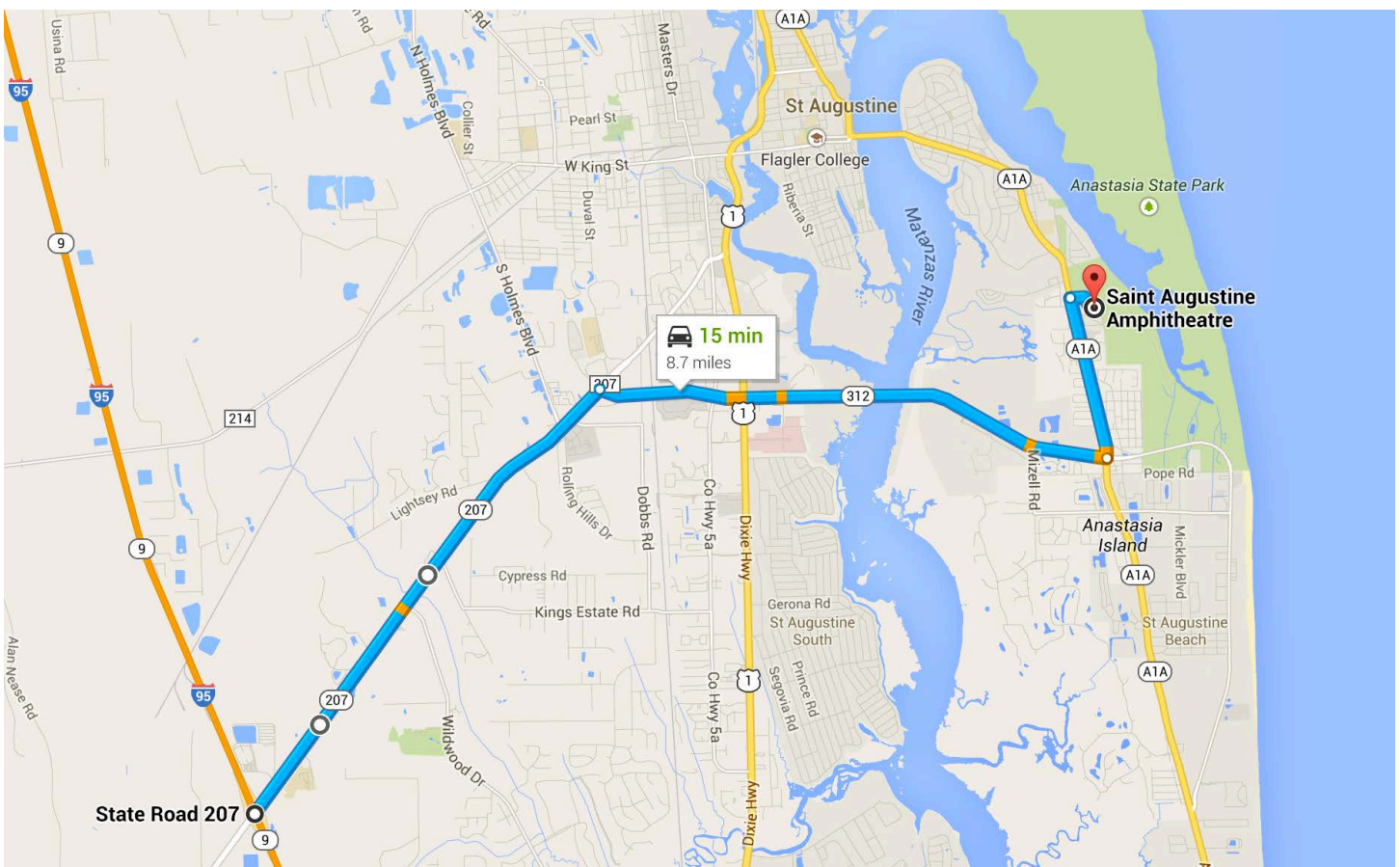

PHOTOS



Stage View



Stage View



Loading Area



Loading Area



Stage Surface